

**FEATURES AND SPECIFICATIONS**
**Features and Benefits**

- Plug latch on top
- Shortened leads with bottom contacts
- Pin and paste solderability
- Shielding meets IEC 950, UL 1863 and CSA 233
- Enhanced panel grounding tabs on shield
- Continuity

**Reference Information**

Product Specification: PS-43860-001

Packaging:

Unshielded—Tube

Shielded—Tray

UL File No.: E107635

CSA File No.: LR149980

Mates With: FCC 68 plugs

Designed In: Inches

**Electrical**

Voltage: 125V

Current: 1.5A

Contact Resistance: 10mΩ max.

Dielectric Withstanding Voltage: 1000V AC

Insulation Resistance: 500 MΩ min.

**Mechanical**

Durability: 500 cycles min.

**Physical**

 Housing: Black glass-filled, high-temperature nylon,  
UL 94V-0

Contact: Gold per FCC 68.5 specification

 Plating: 1.27μm (50μ") min. Gold in contact area and  
1.27μm (50μ") Tin/Lead on solder tails both over  
Nickel overall

Temperature: -40 to +80°C

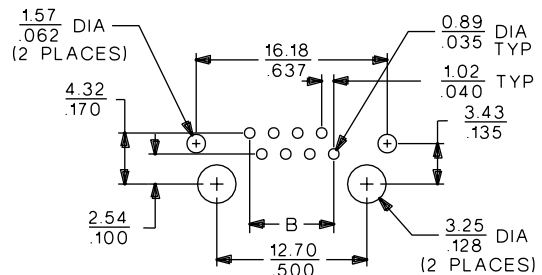
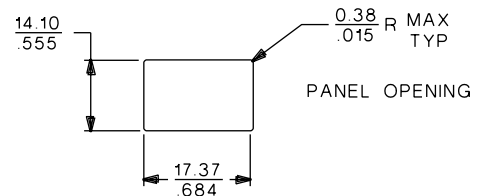
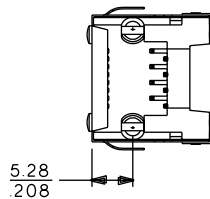
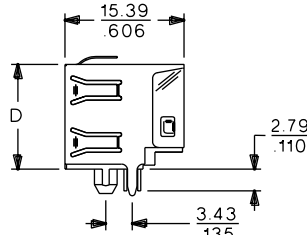
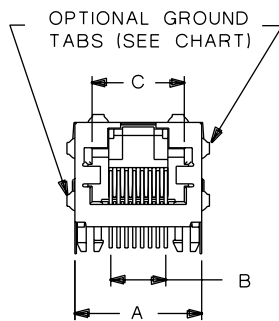
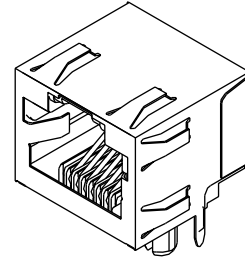
**43860**
**Right Angle, Low Profile  
Inverted, Shielded and  
Unshielded Versions**

 PCB LAYOUT : COMPONENT SIDE  
 RECOMMENDED PCB THICKNESS :  $\frac{.157}{.062}$ 
**ORDERING INFORMATION AND DIMENSIONS**

Circuits	Loaded Contacts	Order No.			Dimension			
		Unshielded	Shielded		A	B	C	D
			With All Panel Grounding Tabs	With Offset Panel Grounding Tabs				
6	4	43860-0003				3.07 (.120)	9.88 (.389)	13.21 (.520)
6	4		43860-0015		16.18 (.637)	3.07 (.120)	9.88 (.389)	13.53 (.533)
6	4			43860-0006	16.18 (.637)	3.07 (.120)	9.88 (.389)	13.53 (.533)
6	6	43860-0002				5.09 (.200)	9.88 (.389)	13.21 (.520)
6	6		43860-0014		16.18 (.637)	5.09 (.200)	9.88 (.389)	13.53 (.533)
6	6			43860-0005	16.18 (.637)	5.09 (.200)	9.88 (.389)	13.53 (.533)
8	8	43860-0001				7.11 (.280)	11.91 (.469)	13.21 (.520)
8	8		43860-0013		16.18 (.637)	7.11 (.280)	11.91 (.469)	13.53 (.533)
8	8			43860-0004	16.18 (.637)	7.11 (.280)	11.91 (.469)	13.53 (.533)