

8

7

6

5

4

3

2

DO NOT SCALE

DIMENSIONS IN MM.

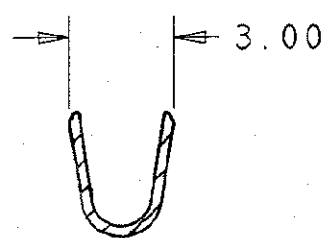
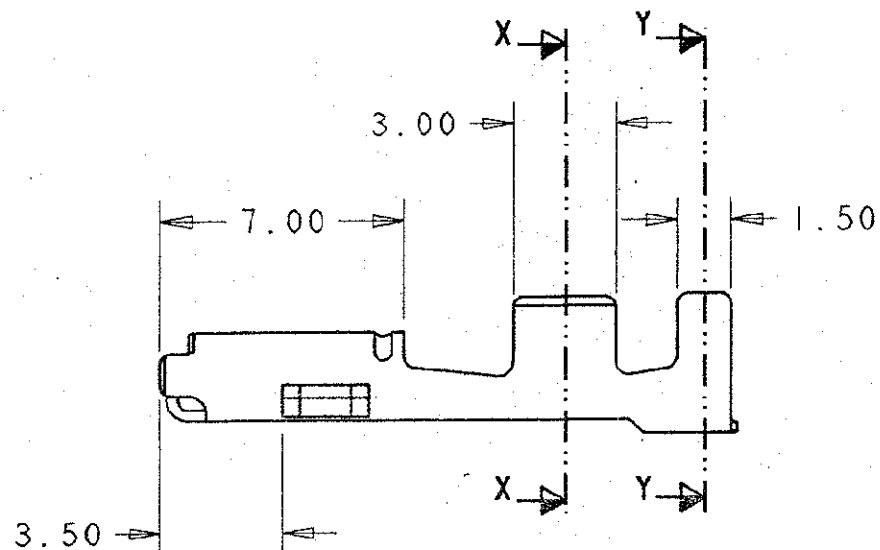
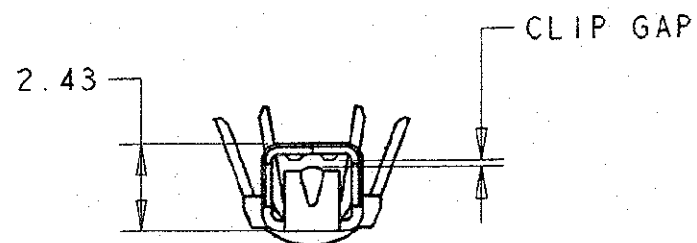
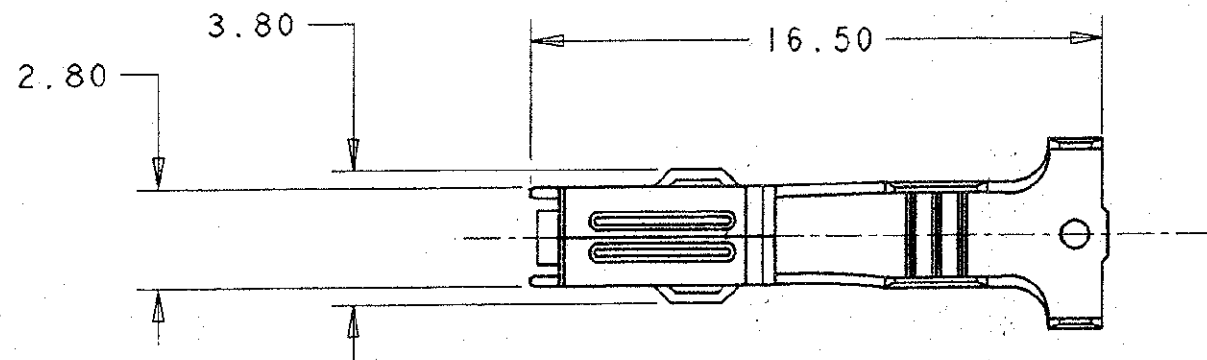
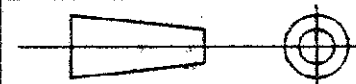

SECTION X-X

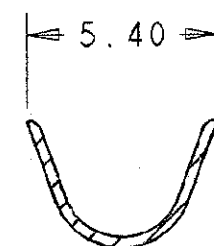

SECTION Y-Y

WIRE RANGE: 0.75 TO 2.00 mm².

FOR SEALED APPLICATIONS, SINGLE WIRES ONLY MUST BE USED.

FOR UNSEALED APPLICATIONS, SINGLE WIRES ARE SUITABLE FOR THE RANGE 0.75 TO 2.00 mm² OR DOUBLE WIRES 2 X 0.50 mm² ONLY.

INSULATION RANGE: SINGLE WIRES 1.65 TO 2.70 MM DIA. OR DOUBLE WIRES 2 X 1.6 MM DIA. ONLY. THIN WALLED CABLE TO BE USED.

PRE-TINNED		BRASS		345806-1	
FINISH		MATERIAL		PART NUMBER	
CUSTOMER DWG FOR REFERENCE ONLY		© COPYRIGHT 1990 BY AMP OF GREAT BRITAIN LTD. ALL INTERNATIONAL RIGHTS RESERVED. ALL PRODUCTS MAY BE COVERED BY BRITISH AND FOREIGN PATENTS AND/OR PATENTS PENDING.		RELEASED FOR PUBLICATION 14 SEP 1990	
		TOLERANCES UNLESS OTHERWISE STATED :		DR. R. S. 14.9.90	
		DEC ± 0.5		CH. R. J. S. APP. J. P.	
		ANGLES ± 1°		AMP of Great Britain Ltd. TERMINAL HOUSE STANMORE MIDD.	
A RELEASED		E800-0041-01 14.02.01		NAME	
3 BOX HT. TOL ALTERED		EB00-0344-95 10.10.95		.070 RECEPTACLE ECONOSEAL 3	
2 REL. TO CUSTOMER		C8171 24.04.92		SCALE	
1 PRELIM. ISSUE		14.09.90		LOC	
REV		APPROVED		ECN	
		DATE		SIZE	
		5 / 1		DWG. No.	
		E		C345806	
		A 3		REV	
				A	
				SHEET	
				1 / 1	