

THIS DRAWING IS UNPUBLISHED. RELEASED FOR PUBLICATION  
 © COPYRIGHT BY TYCO ELECTRONICS CORPORATION. ALL RIGHTS RESERVED.

| LOC | DIST | REVISIONS   |              |         |       |
|-----|------|-------------|--------------|---------|-------|
| P   | LTR  | DESCRIPTION | DATE         | DWN     | APVD  |
| AD  | 00   | Z           | ECO-06-11106 | 10AUG06 | MB NE |

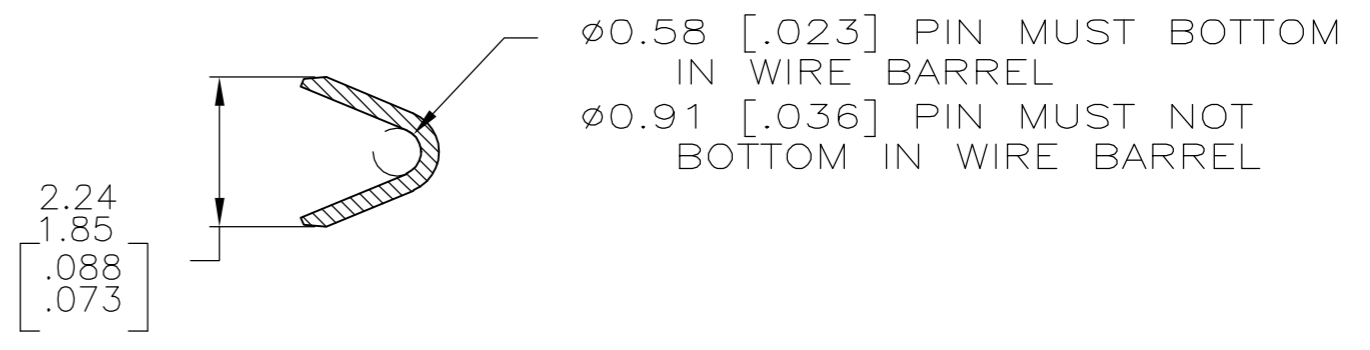
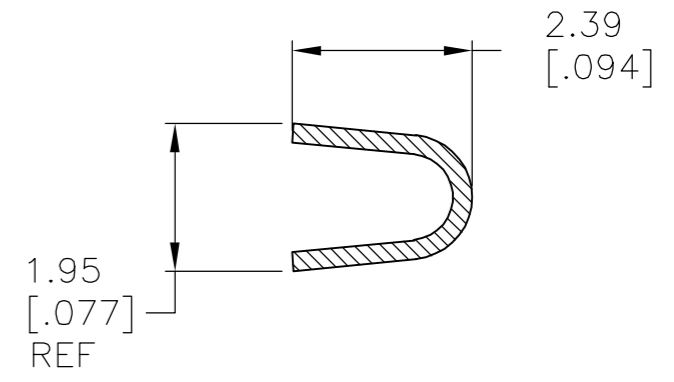
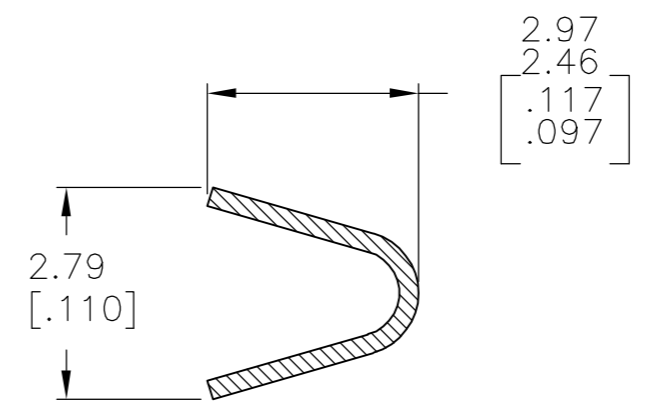
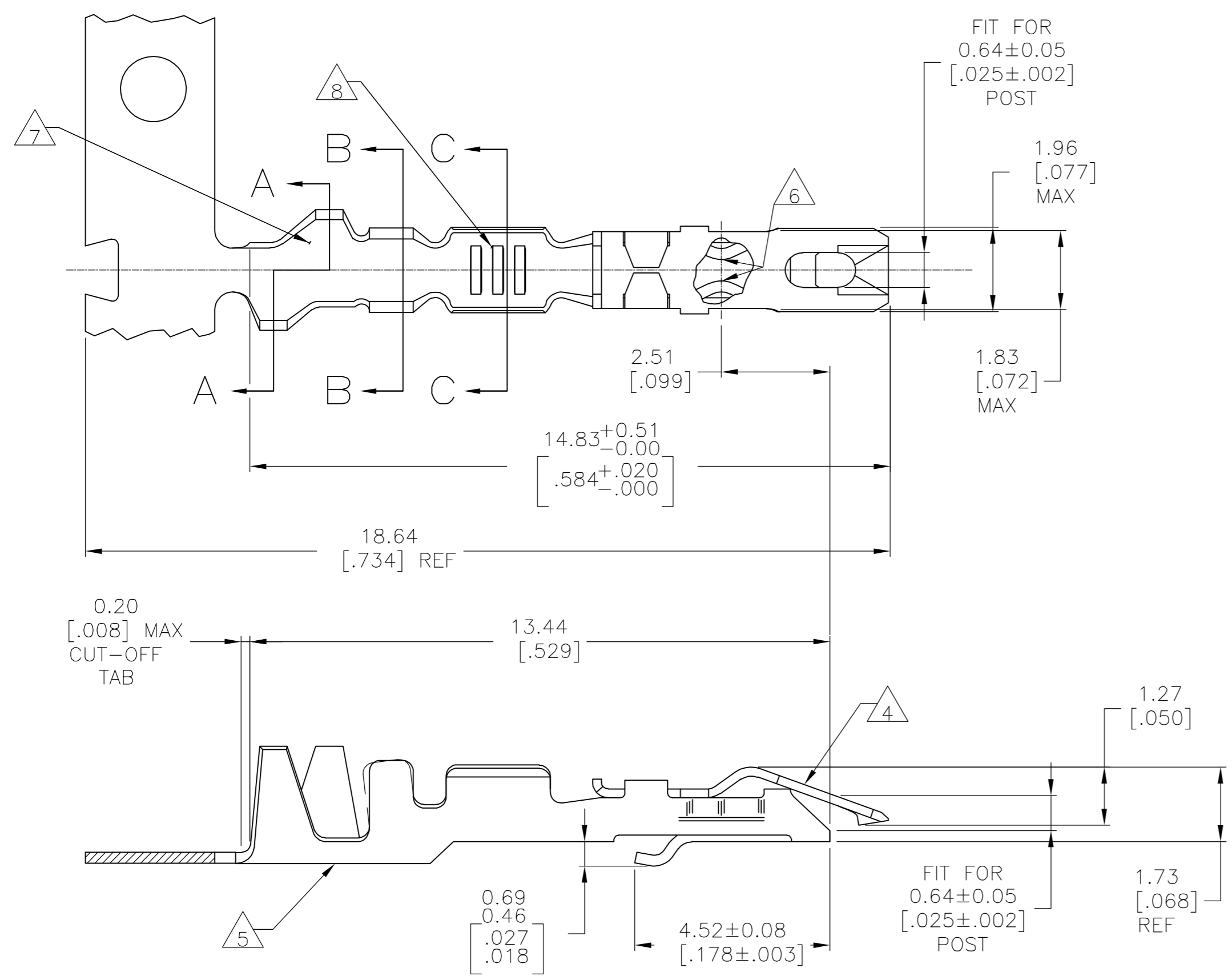

1. REELED FOR MINI APPLICATOR.
2. PLATED WITH .00254 [.000100] TIN LEAD OVER .00127 [.000050] NICKEL ENTIRE CONTACT.
3. PLATED WITH .00076 [.000030] GOLD IN CONTACT AREA, GOLD FLASH ON REMAINDER, OVER .00127 [.000050] NICKEL.
4. SPRING MATERIAL: STAINLESS STEEL.
5. BODY MATERIAL: PHOSPHORUS BRONZE (SEE TABLE FOR FINISH.)
6. POINT OF PLATING MEASUREMENT.
7. INSULATION BARREL RANGE ø0.71 [.038]-ø1.57 [.062].
8. WIRE BARREL RANGE #20
9. PLATED WITH .00254 (.000100) TIN OVER .00127 (.000050) NICKEL, ENTIRE CONTACT.

SUPERSEDED BY 5-867052-1

|        |             |
|--------|-------------|
| 9      | 5-867052-1  |
| 9      | 867052-3    |
| 3      | 867052-2    |
| 2      | 867052-1    |
| FINISH | PART NUMBER |

|   |  |        |             |           |   |               |
|---|--|--------|-------------|-----------|---|---------------|
| THIS DRAWING IS A CONTROLLED DOCUMENT.  |  | DWN    | E.BRANDBERG | 17-1-93   | Tyco Electronics Corporation<br>Harrisburg, Pa 17105-3608 |               |
| DIMENSIONS: mm [INCHES]   |  | CHK    | S. SHUEY    | 26-1-93   | CONTACT ASS'Y, LOCKING CLIP.<br>FOR .025 SQUARE POST.     |               |
| TOLERANCES UNLESS OTHERWISE SPECIFIED:  |  | APVD   | -           | -         | PRODUCT SPEC 108-36028<br>APPLICATION SPEC 114-25006      |               |
| 0 PLC ± -<br>1 PLC ± -<br>2 PLC ± -<br>3 PLC ± 0.13[.005]<br>4 PLC ± -<br>ANGLES ± -<br>FINISH AS SHOWN |  | WEIGHT | -           | SIZE      | A2  | RESTRICTED TO |
| MATERIAL AS SHOWN   |  | FINISH | AS SHOWN    | CAGE CODE | 00779   | DRAWING NO    |
| CUSTOMER DRAWING  |  | SCALE  | 10:1        | DWG NO    | C=867052  | SHEET 1 OF 1  |
|   |  | REV    | Z           |           |   |               |