

BL socket blocks BL
tin-plated version

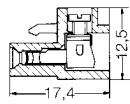

BL TOP socket blocks
tin-plated version

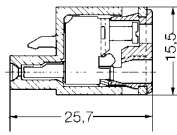
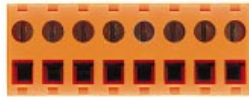

SL pin headers
tin-plated version, 90°

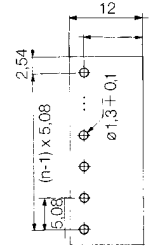
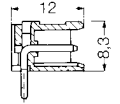

BL 2...16

Pitch 5,08 mm

No. of poles	Type	Cat.No.	Qty.
2	BL 2 SN OR	125916	100
3	BL 3 SN OR	125926	100
4	BL 4 SN OR	125936	100
5	BL 5 SN OR	125946	50
6	BL 6 SN OR	125956	50
7	BL 7 SN OR	125966	50
8	BL 8 SN OR	125976	50
9	BL 9 SN OR	125986	50
10	BL 10 SN OR	125996	50
11	BL 11 SN OR	126006	50
12	BL 12 SN OR	126016	50
13	BL 13 SN OR	126026	50
14	BL 14 SN OR	126036	50
15	BL 15 SN OR	126046	50
16	BL 16 SN OR	127546	50

BL TOP 2...12

Pitch 5,08 mm

No. of poles	Type	Cat.No.	Qty.
2	BL TOP 2 SN OR	133586	
3	BL TOP 3 SN OR	133596	
4	BL TOP 4 SN OR	133606	
5	BL TOP 5 SN OR	133616	
6	BL TOP 6 SN OR	133626	
7	BL TOP 7 SN OR	133636	
8	BL TOP 8 SN OR	133646	
9	BL TOP 9 SN OR	133656	
10	BL TOP 10 SN OR	133666	
11	BL TOP 11 SN OR	133676	
12	BL TOP 12 SN OR	133686	

SL 2...15

Solder version / pin length 3,2 mm / Pitch 5,08 mm

No. of poles	Type	Cat.No.	Qty.
2	SL 2/90 3.2SN OR	126686	100
3	SL 3/90 3.2SN OR	126696	100
4	SL 4/90 3.2SN OR	126706	100
5	SL 5/90 3.2SN OR	126716	50
6	SL 6/90 3.2SN OR	126726	50
7	SL 7/90 3.2SN OR	126736	50
8	SL 8/90 3.2SN OR	126746	50
9	SL 9/90 3.2SN OR	126756	50
10	SL 10/90 3.2SN OR	126766	50
11	SL 11/90 3.2SN OR	126776	50
12	SL 12/90 3.2SN OR	126786	50
13	SL 13/90 3.2SN OR	126796	50
14	SL 14/90 3.2SN OR	126806	50
15	SL 15/90 3.2SN OR	126816	50

SL 2...15

Solder version / pin length 4,5 mm / Pitch 5,08 mm

No. of poles	Type	Cat.No.	Qty.
2	SL 2/90 4.5SN OR	011266	100
3	SL 3/90 4.5SN OR	011256	100
4	SL 4/90 4.5SN OR	011246	100
5	SL 5/90 4.5SN OR	011236	50
6	SL 6/90 4.5SN OR	011226	50
7	SL 7/90 4.5SN OR	011216	50
8	SL 8/90 4.5SN OR	011206	50
9	SL 9/90 4.5SN OR	011196	50
10	SL 10/90 4.5SN OR	011186	50
11	SL 11/90 4.5SN OR	011176	50
12	SL 12/90 4.5SN OR	011166	50
13	SL 13/90 4.5SN OR	011156	50
14	SL 14/90 4.5SN OR	011146	50
15	SL 15/90 4.5SN OR	069236	50

BL 2...15¹⁾

Pitch 5,00 (beige)

No. of poles	Type	Cat.No.	Qty.
2	BL 2 SN BE F.STIFT 1,6	022696	100
3	BL 3 SN BE F.STIFT 1,6	022706	100
4	BL 4 SN BE F.STIFT 1,6	022716	100
5	BL 5 SN BE F.STIFT 1,6	022726	50
6	BL 6 SN BE F.STIFT 1,6	022736	50
7	BL 7 SN BE F.STIFT 1,6	022746	50
8	BL 8 SN BE F.STIFT 1,6	022756	50
9	BL 9 SN BE F.STIFT 1,6	022766	50
10	BL 10 SN BE F.STIFT 1,6	022776	50
11	BL 11 SN BE F.STIFT 1,6	022786	50
12	BL 12 SN BE F.STIFT 1,6	022796	50
13	BL 13 SN BE F.STIFT 1,6	022806	50
14	BL 14 SN BE F.STIFT 1,6	022816	50
15	BL 15 SN BE F.STIFT 1,6	022826	50

SL 2...15

Solder version / pin length 4,5 mm / Pitch 5,00 mm

No. of poles	Type	Cat.No.	Qty.
2	SL 2/90 4.5SN BE	022976	100
3	SL 3/90 4.5SN BE	022986	100
4	SL 4/90 4.5SN BE	022996	100
5	SL 5/90 4.5SN BE	023006	50
6	SL 6/90 4.5SN BE	023016	50
7	SL 7/90 4.5SN BE	023026	50
8	SL 8/90 4.5SN BE	023036	50
9	SL 9/90 4.5SN BE	023046	50
10	SL 10/90 4.5SN BE	023056	50
11	SL 11/90 4.5SN BE	023066	50
12	SL 12/90 4.5SN BE	023076	50
13	SL 13/90 4.5SN BE	023086	50
14	SL 14/90 4.5SN BE	023096	50
15	SL 15/90 4.5SN BE	023106	50

¹⁾ Also usable with BL H ST 1.6