

MATERIALS AND FINISHES:

BODY, CLAMP BODY, CLAMP, NUT, C'NUT, WASHER: BRASS
 PLATED: NICKEL

CENTER/INTERMEDIATE CONTACT: BRASS
 PLATED: GOLD

INSULATOR: TEFLON

SPRING WASHER: BeCu
 PLATED: NICKEL

GASKET: SILICONE RUBBER

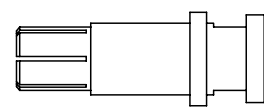
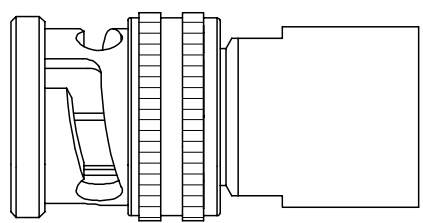
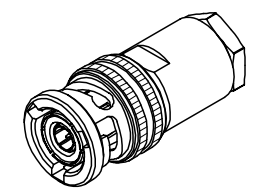
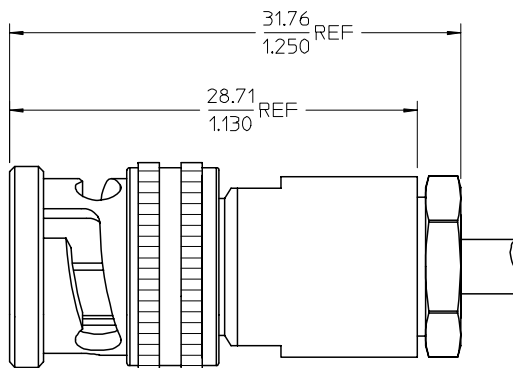

INTERMEDIATE CONTACT



FRONT INSULATOR

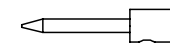

CONTACT

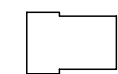

REAR INSULATOR

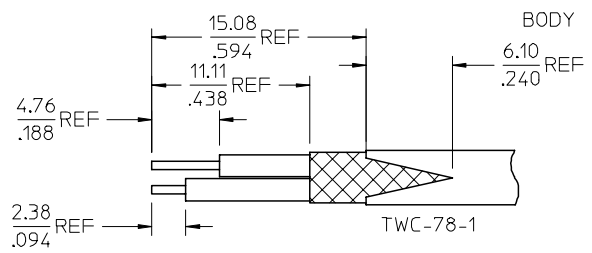

RECOMMENED STRIPPING DIMENSIONS

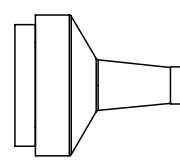

CLAMP BODY/INS

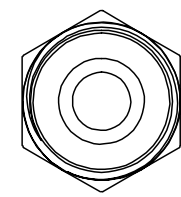

CLAMP/NUT

73175-0021	73175-0020, ONE PER BAG
73175-0020	BULK
PART NO.	PACKAGING

MIL-STD-348A, FIG. 201-1	INTERFACE
SPECIFICATION	DESCRIPTION

CHG: NEW RELEASE
 FC NO: URF2008-0108
 DRAWN: FLAHERTY 2007/08/17
 CHKD: SHAH 2007/08/17
 APPR: JIMENER 2007/08/17

QUALITY SYMBOLS	GENERAL TOLERANCES (UNLESS SPECIFIED)
▽=0	mm INCH
▽=0	4 PLACES ± --- ± ---
	3 PLACES ± --- ± ---
	2 PLACES ± --- ± ---
	1 PLACE ± --- ± ---
	ANGULAR ± 2 °
	DRAFT WHERE APPLICABLE MUST REMAIN WITHIN DIMENSIONS

DIMENSION STYLE	SCALE
MM/IN	DESIGN UNITS
DRAWN BY	METRIC
DATE	THIRD ANGLE PROJECTION
SSS 2003/12/19	
CHECKED BY	
TEF 2003/12/19	
APPROVED BY	
GMH 2003/12/17	
MATERIAL NO.	
SEE TABLE	

TITLE	
TRIAx PLUG STR 3 LUG	
TWC-78-1 TWINAX CABLE	
TRIAx-PC	
MOLEX INCORPORATED	
DOCUMENT NO.	SHEET NO.
SD-73175-002	1 OF 1
THIS DRAWING CONTAINS INFORMATION THAT IS PROPRIETARY TO MOLEX INCORPORATED AND SHOULD NOT BE USED WITHOUT WRITTEN PERMISSION	