

# Customer Information Sheet

DRAWING No.: M80-530XX22

SHEET 2 OF 2

IF IN DOUBT - ASK

©

NOT TO SCALE

THIRD ANGLE PROJECTION

ALL DIMENSIONS IN mm

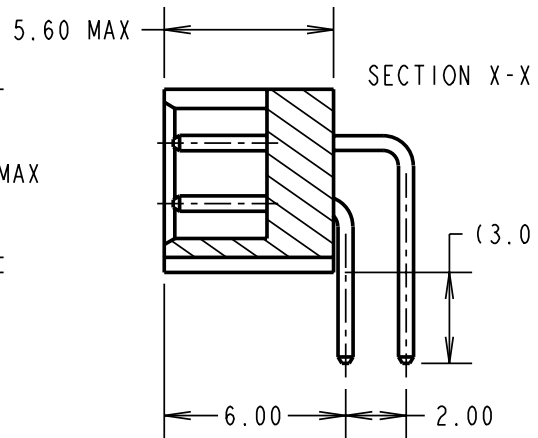
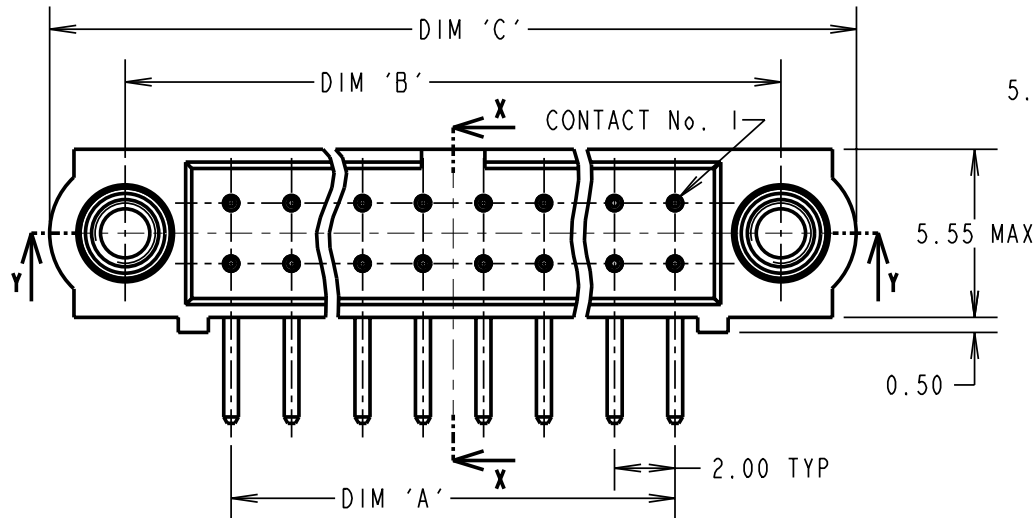

**SPECIFICATIONS:**

**MATERIAL:**  
 MOULDING = GLASS-FILLED PPS,  
 UL94V-0, BLACK  
 CONTACT = PHOSPHOR BRONZE  
 JACKSCREW = STAINLESS STEEL  
**FINISH:**  
 CONTACT = 0.75µ GOLD ON CONTACT AREA,  
 3µ 90/10 TIN/LEAD ON TAILS

**ELECTRICAL:**  
 CURRENT RATING AT 25°C = 3.0A MAX  
 CURRENT RATING AT 85°C = 2.2A MAX  
 WORKING VOLTAGE = 120V AC/DC  
 VOLTAGE PROOF = 360V AC/DC  
 CONTACT RESISTANCE = 25 mΩ MAX  
 INSULATION RESISTANCE = 100 MΩ MIN

**MECHANICAL:**  
 DURABILITY = 500 OPERATIONS  
**ENVIRONMENTAL:**  
 TEMPERATURE RANGE = -55°C TO +125°C

**PACKING:**  
 TUBE  
 FOR COMPLETE SPECIFICATION, SEE  
 COMPONENT SPECIFICATION C005XX  
 (LATEST ISSUE)

**ORDER CODE:**  
**M80-530XX22**

No. OF CONTACTS  
 06, 10, 14, 20,  
 26, 34, 42, 50

FINISH  
 22 - SELECTIVE GOLD

**NOTES:**  
 1. RECOMMENDED PCB HOLE  
 SIZE =  $\varnothing 0.65$ mm MIN.

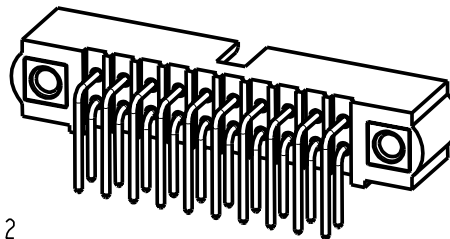
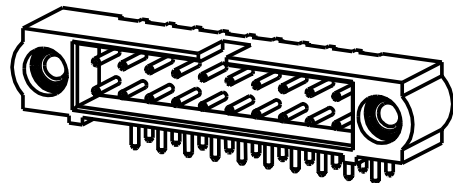
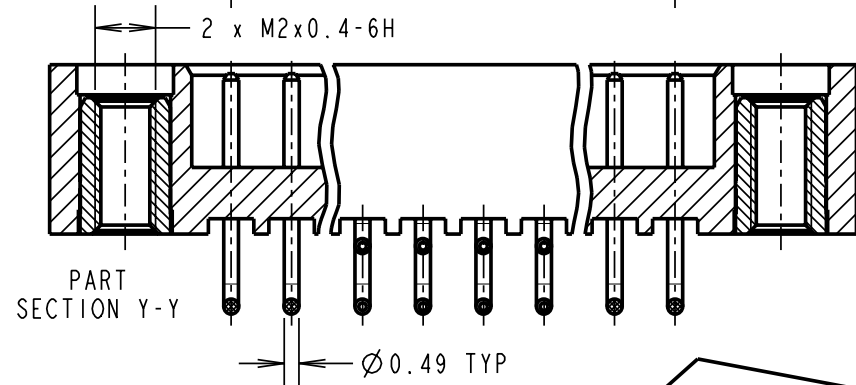

SCALE 2

ASSEMBLY PART No.	No. OF CONTACTS	DIM 'A'	DIM 'B'	DIM 'C'
M80-5300622	6	4.00	11.00	16.00
M80-5301022	10	8.00	15.00	20.00
M80-5301422	14	12.00	19.00	24.00
M80-5302022	20	18.00	25.00	30.00
M80-5302622	26	24.00	31.00	36.00
M80-5303422	34	32.00	39.00	44.00
M80-5304222	42	40.00	47.00	52.00
M80-5305022	50	48.00	55.00	60.00

WJB	A	05.06.03	----
NAME	ISS.	DATE	C/NOTE
APPROVED: P. D. COLLINS			
CHECKED: M. G. PLESTED			
DRAWN: W. J. BOURNE			
CUSTOMER REF.:			
ASSEMBLY DRG:			

## HARWIN

THIS DRAWING AND ANY INFORMATION OR DESCRIPTIVE MATTER SET OUT HEREON ARE CONFIDENTIAL AND COPYRIGHT PROPERTY OF THE HARWIN GROUP AND MUST NOT BE DISCLOSED, LOANED, COPIED OR USED FOR MANUFACTURING, TENDERING OR FOR ANY OTHER PURPOSE WITHOUT THEIR WRITTEN PERMISSION.

**TOLERANCES**  
 X. = ±1mm  
 X.X = ±0.25mm  
 X.XX = ±0.10mm  
 X.XXX = ±0.01mm  
 ANGLES = ±5°  
 UNLESS STATED

**MATERIAL:**  
 SEE ABOVE

**FINISH:**  
 SEE ABOVE

**S/AREA:**  
 mm<sup>2</sup>

**TITLE:** JACKSCREW DATAMATE  
 DIL HORIZONTAL PC TAIL  
 MALE ASSEMBLY

**DRAWING NUMBER:** M80-530XX22

SHT 2 OF 2

<b>HARWIN INC</b> U.S.A. TEL: (812) 542 2546 FAX: (812) 542 2541	<b>HARWIN PLC</b> U.K. TEL: 023 9237 0451 FAX: 023 9231 4590	<b>HARWIN PTE</b> SINGAPORE TEL: 65 6779 4909 FAX: 65 6779 3868
---	---	--