

ALL RIGHTS RESERVED. NO PORTION OF THIS PUBLICATION, WHETHER IN WHOLE OR IN PART CAN BE REPRODUCED WITHOUT THE EXPRESS WRITTEN CONSENT OF SPC TECHNOLOGY.

REVISIONS		DOC. NO.	SPC-F005	Effective:	12/21/98	DCP No:	880
DCP #	REV	DESCRIPTION	DRAWN	DATE	CHECKD	DATE	APPRVD
	A	Redrawn in AutoCad	JAP	11/28/91			
1199	B	Renamed: was CBS-T0-****HT	JWM	01/03/02	JC	1/4/02	JC

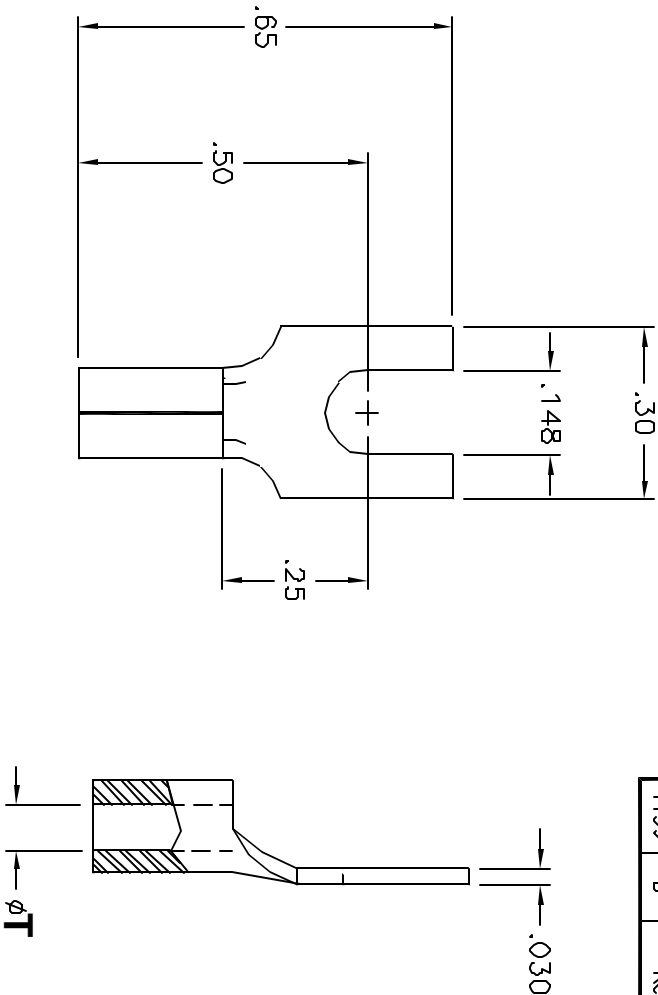

NOTES:

1. MATERIAL: NICKEL-PLATED ALLOY STEEL
2. CONTINUOUS OPERATING TEMPERATURE: 900°F (482°C)
3. VOLTAGE RATING: 600 V

PART NUMBER	WIRE RANGE (AWG)	STUD SIZE	T
CBS-T0-1406-HT	16 - 14	#6	.138
CBS-T0-1806-HT	22 - 18	#6	.138
			.070

DISCLAIMER
 ALL STATEMENTS AND TECHNICAL INFORMATION CONTAINED HEREIN ARE BASED UPON INFORMATION AND/OR TESTS WE BELIEVE TO BE ACCURATE AND RELIABLE. SINCE CONDITIONS OF USE ARE BEYOND OUR CONTROL, THE USER SHALL DETERMINE THE SUITABILITY OF THE PRODUCT FOR THE INTENDED USE AND ASSUME ALL RISK AND LIABILITY WHATSOEVER IN CONNECTION THEREWITH.

Tolerances: Unless Otherwise Specified:

- X = ±.015
- .XX = ±.010
- .XXX = ±.005

DRAWN BY:	DATE:
JC	3/7/91
CHECKED BY:	DATE:
JOHN COLE	11/27/91
APPROVED BY:	DATE:
JL	11/27/91

DRAWING TITLE: **High Temperature Spade Terminals**



SPC TECHNOLOGY

SIZE	DWG. NO.	ELECTRONIC FILE	REV
A	TA-479	TA-479	B
SCALE:	NTS	U.O.M.: INCHES [mm]	SHEET: 1 OF 1