

- Concave cross-section for comfortable thumb grip
- Matt black plastic
- Supplied with fixing hardware

Carrying capacity 75kg

Order Multiple=2		Price Each			
Mfrs. List No.	Order Code	2+	10+	20+	40+
3212.1200	306-0962				

H284

## Tubular

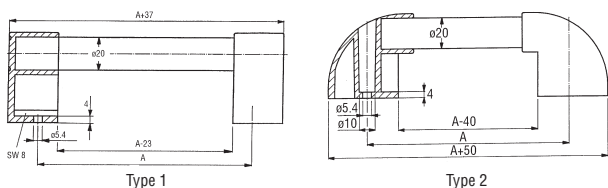
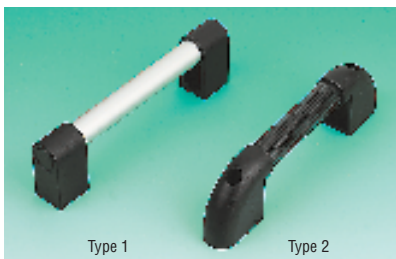

- Natural anodised aluminium handle (Type 1)
- Black plastic-coated aluminium handle (Type 2)
- Black polyamide brackets
- Fixing hardware should be ordered separately

H306

Fixing Centres (A)	Mfrs. List No.	Order Code	Price Each			
			1+	5+	10+	20+
<b>Type 1</b>						
150	3200.1501	306-1498				
200	3200.2001	306-1504				
300	3200.3001	306-1516				
<b>Type 2</b>						
150	3200.1513	306-1528				
200	3200.2013	306-1530				
300	3200.3013	306-1541				

## Equipment

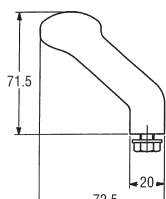
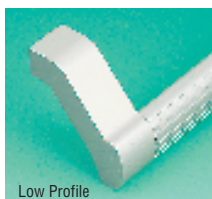
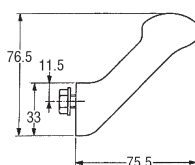
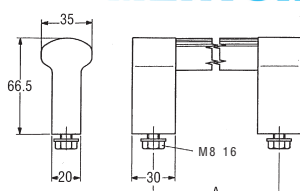
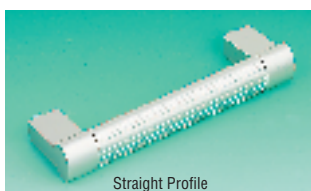

- Professional sturdy design
- Attractive anodised aluminium

- Choice of straight, high or low profile
- Supplied with fixing hardware

Carrying capacity 100kg

H286

Colour	Fixing Centres (A)	Mfrs. List No.	Order Code	Price Each		
				1+	4+	12+
<b>Straight Profile</b>						
Natural	200	3310.2101	305-8785			
Natural	300	3310.3101	305-8797			
Natural	400	3310.4101	305-8803			
Black	200	3310.2103	305-8815			
Black	300	3310.2103	305-8827			
Black	400	3310.4103	305-8839			
<b>High Profile</b>						
Natural	200	3310.2301	305-8840			
Natural	300	3310.3301	305-8852			
Natural	400	3310.4301	305-8864			
Black	200	3310.2303	305-8876			
Black	300	3310.3303	305-8906			
Black	400	3310.4303	305-8918			
<b>Low Profile</b>						
Natural	200	3310.2201	305-8920			
Natural	300	3310.3201	305-8931			
Natural	400	3310.4201	305-8943			
Black	200	3310.2203	305-8955			
Black	300	3310.3203	305-8967			
Black	400	3310.4203	305-8979			

## Stainless Steel

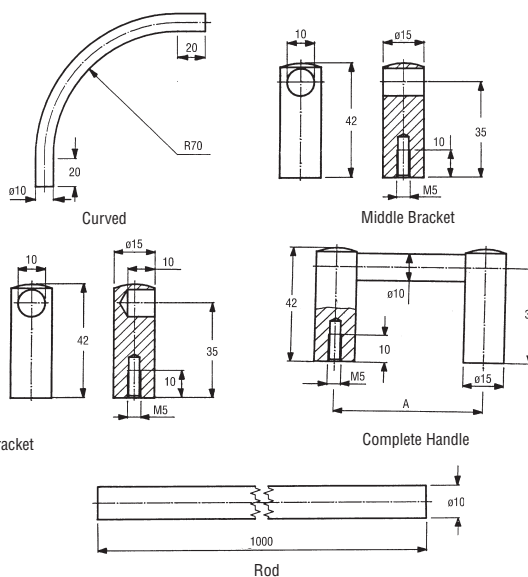
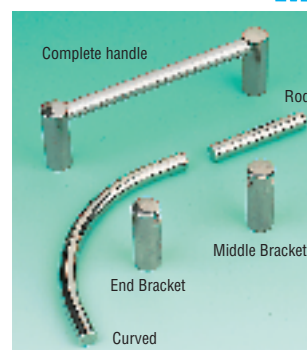

- Rustproof stainless steel
- Available as a complete handle or individual parts
- Can be used for handles or decorative rails

Carrying capacity 100kg

H307

Fixing Centres (A)	Mfrs. List No.	Order Code	Price Each			
			1+	5+	10+	20+
<b>Handles Complete</b>						
55	3401.0551	306-1863				
88	3401.0881	306-1875				
120	3401.1201	306-1887				
180	3401.1801	306-1899				
235	3401.2351	306-1905				
<b>End Bracket</b>	3401.0101	306-2120				
<b>Middle Bracket</b>	3401.0111	306-2132				
<b>Curved Section</b>	3401.1091	306-2144				
<b>Rod (1M)</b>	3401.1001	306-2156				

continued