

	Mfrs. List No.	Order Code	Price Each				
			1+	10+	25+	50+	100+
Free plug	9206-419ARPA2	.439-320					
Free socket	9201-419ARSA2	.439-332					
Panel plug	9209-419ARP2	439-344					
Panel socket	9202-419ARS2	439-356					

'R' Series 2.5 Circular Connectors 'Clockwise'

CONTACT

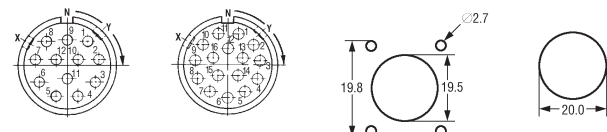
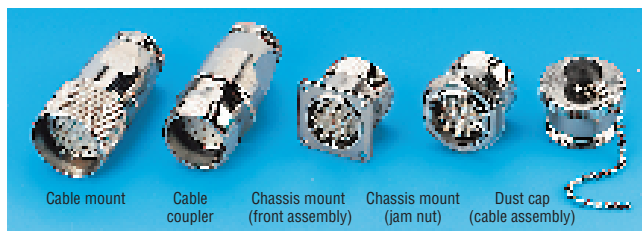

- A range of nickel plated circular connectors
- Solder bucket contacts
- Complete with EMC spring for full 360° RFI shielding
- Cable mount and cable coupler are fitted with PG cable gland
- Chassis mount version available as front assemblies or single through-hole assemblies complete with gasket
- Clockwise and numbering
- IP65 rating

Current rating:	7.5A	Housing:	Copper alloy, nickel plated
Rated voltage:	9 and 12 way	Insulator	Thermoplastic UL94-V0
	380Vac		
	16 Way 250Vac		
Withstand voltage:	1.5KV	Contacts:	Coper alloy, silver plated
Insulation resistance:	≥ 10 ¹⁰ MΩ	Wire/conductor dia:	9 way 6-10mm
Contact resistance:	≤ 3mΩ		12 and 16 way 8-12mm
Temperature range:	-40°C to +125°C	Thread size:	9 way PG9
			12 and 16 way PG11

CM431

Cable Coupler 'With EMC Spring'

CONTACT

CM432

No. of Ways.	Mfrs. List No.	Order Code	Price Each				
			1+	10+	50+	100+	250+
Pin Contacts							
9	876+00022020	630-550					
12	8990+00022020	630-561					
16	8883+00022030	630-573					
Socket Contacts							
9	8771+00022020	630-524					
12	8923+00022030	630-536					
16	8722+00022030	630-548					

Cable Coupler 'With EMC Spring'

CONTACT

CM434

No. of Ways.	Mfrs. List No.	Order Code	Price Each				
			1+	10+	50+	100+	250+
Pin Contacts							
9	9232+00022020	630-585					
12	9095+00022030	630-597					
16	9684+00022030	630-767					
Socket Contacts							
9	8843+00022020	630-779					
12	9198+00022030	630-780					
16	9143+00022030	631-190					

Chassis Mount

CONTACT

CM436

No. of Ways	Mfrs. List No.	Order Code	Price Each				
			1+	10+	50+	100+	250+
Front Assembly with Gasket							
Pin Contacts							
9	8764+50.101200	631-206					
12	8702+50.101200	631-218					
16	8701+50.101200	632-041					

continued

No. of Ways	Mfrs. List No.	Order Code	Price Each				
			1+	10+	50+	100+	250+
Socket Contacts							
9	8705+50.101200	632-053					
12	8703+50.101200	632-156					
16	8707+50.101200	633-150					
Jam Nut with Sealing Ring							
Pin contacts							
9	9002+50.106202	633-161					
12	9159+50.106202	633-598					
16	8885+50.106202	633-604					
Socket Contacts							
9	8728+50.106202	633-616					
12	8727+50.106202	633-665					
16	8945+50.106202	633-677					

Accessories

CONTACT

CM435

Type	Mfrs. List No.	Order Code	Price Each				
			1+	10+	50+	100+	250+
Cable Mount - Dust Cap							
9 way - PG9	50.104105	.633-689					
12 & 16 way-PG11	50.104104	.633-690					
Cable Coupler - Dust Cap							
9 way - PG9	50.105105	.633-707					
12 & 16 way-PG11	50.105104	.633-719					
Chassis Mount - Dust Cap							
Front assembly	50.101102	.633-720					
Jam nut	50.106107	.633-732					
Assembly Tool	50.100800	.633-823					

LS1 Circular Connector

CONTACT

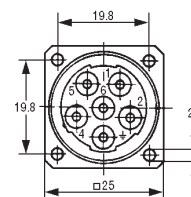

- 5 pin + earth connector for the machine tool industry
- Complete with PG16 strain relief skin top cable gland
- EMC spring with cable socket for 360°C screening
- IP65 rated

Contact rating	22A(max)	Housing (Hood)	Copper alloy, nickel plated
Voltage rating	600Vac	Insulator	Thermoplastic resin, UL94-V0
Test Voltage	2.5KVac	Termination	Crimp contacts
Contact resistance	≤3mΩ	Wire size	1.0-2.5mm ²
Temperature range	-40°C to +125°C		

Mfrs. List No:	14.210010+12.9454+00022050 = 633-744,	14.210015+101200 = 633-756,
	14.210015+101200 = 633756,	14.210050 = 633768,
	14.210051 = 633-770,	14.210005 = 633-781,
	14.210006 = 633-743	

CM430

No. of Ways.	Order Code	Price Each				
		1+	10+	50+	100+	250+
Cable Socket - With EMC Spring						
5+ Earth	633-744 †					
Chassis Plug - With Gasket						
5+ Earth	633-756 †					
Order Multiple=6		6+	60+	300+	600+	1500+
Crimp Contacts						
Pin (1-1.5mm ²)	633-768 †					
Pin (2.5mm ²)	633-770 †					
Socket (1-1.5mm ²)	633-781 †					
Socket (2.5mm ²)	633-793 †					

† Available until stocks are exhausted

continued

New Products

For more information on new products check out the New Product Guide.